



## nLight® UNITOUCH

Seamless control,  
modern and intuitive



The nLight® UNITOUCH is a Bluetooth® enabled touchscreen wall switch that provides seamless control of luminaires and devices on the nLight lighting controls platform through a single piece of glass or the MyPersonify mobile app. As the perfect blend of aesthetic design and user experience, the nLight UNITOUCH is an easy-to-install wall switch that's ideal for commercial, educational, hospitality, and retail applications.

### Benefits

- **Modern Form Factor** – Provides a sleek and clean design with a contemporary aesthetic to enhance the look and feel of your space or project
- **Intuitive User Interface** – Delivers an exceptional user experience combined with an easy to read and navigate interface using common icons
- **Mobile App** – Equipped with Bluetooth® Low Energy (BLE), the nLight UNITOUCH enables users the ability to remotely control lights and shades through the MyPersonify mobile app
- **Multi-zone, Scene and Shade Control** – All three on one wall switch for complex spaces and projects
- **Security/Access** – User access levels to ensure the highest level of protection for your organization. Two user access levels with full access to configure for administrators and control only access for occupants in the space.

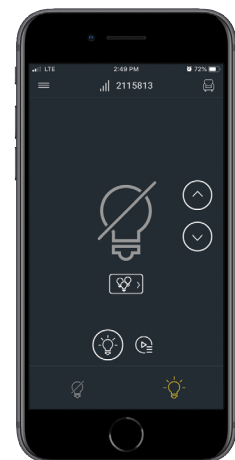

The Bluetooth® word mark and logos are registered trademarks owned by Bluetooth SIG, Inc. and any use of such marks by Acuity Brands is under license. Other trademarks and trade names are those of their respective owners.



## nLight Wired Devices and Luminaires

The nLight® UNITOUCH is a touchscreen wall switch that allows local configuration and control of lighting zones.

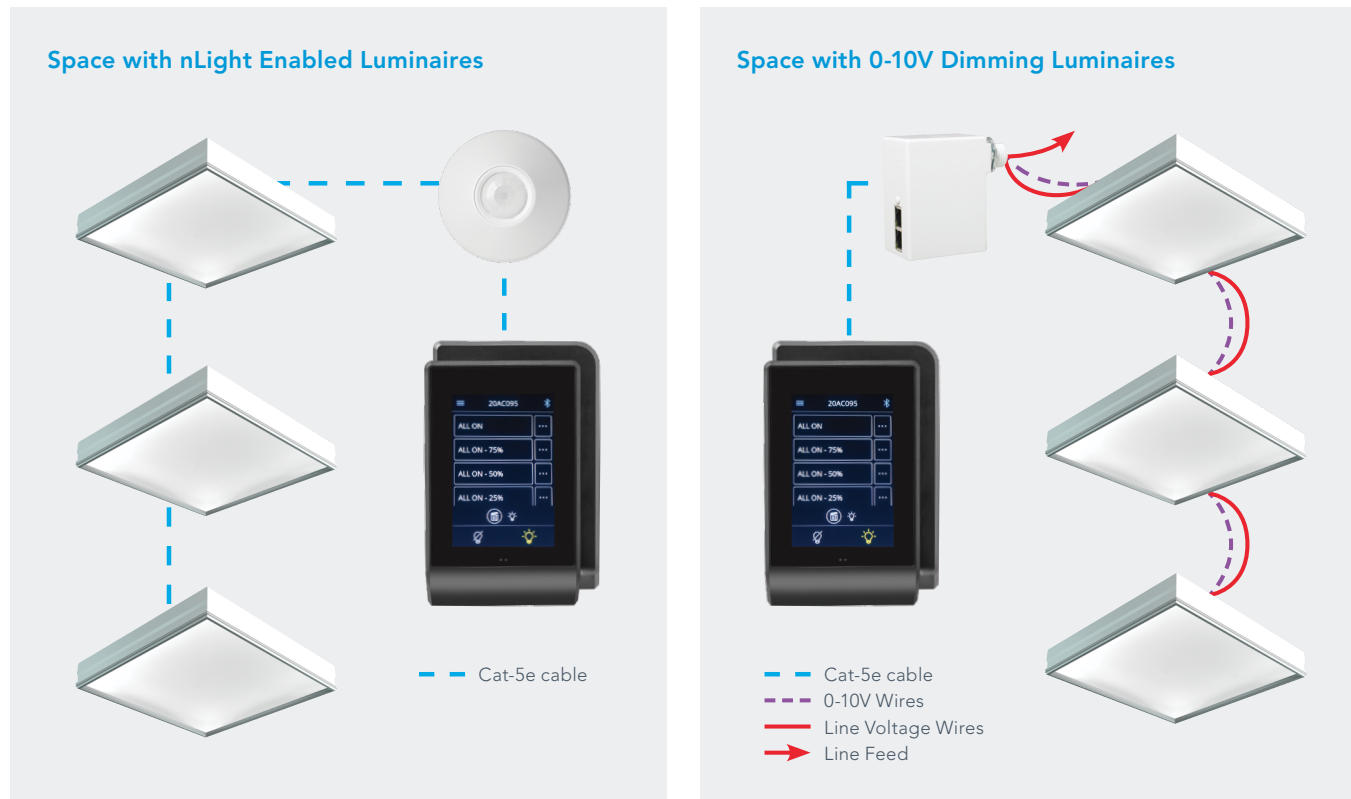

To learn more about the nLight lighting controls platform, contact your local lighting representative or visit [www.acuitybrands.com/nLight](http://www.acuitybrands.com/nLight).